

The product using material and processing must conform to the "WI-PZ-001"HSF technical standard control requirements

RoHS

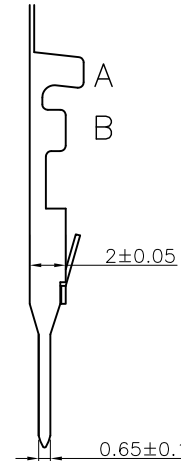
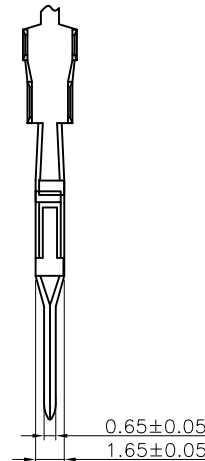
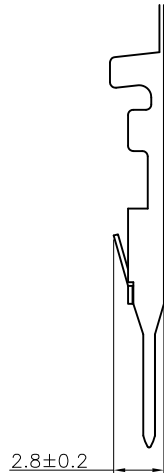
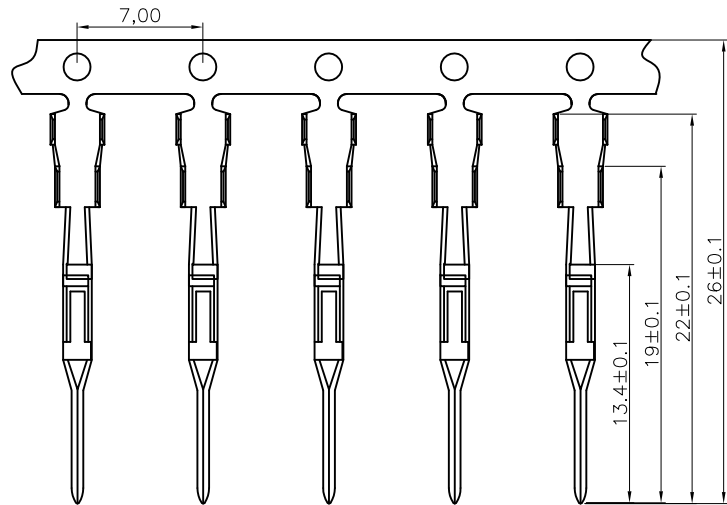

NOTE:

- 1.MATERIAL SPECIFICATION:
 - 1-1.TERMINAL:BRASS
 - 1-2.APPLICABLE WIRE:AWG#20~#26
- 2.PLATING SPECIFICATION:
 - 2-1.TREMINAL:
 - TIN-PLATED ON CONTACT AREA.
- 3.MECHANICAL PERFORMANCE:
 - 3-1.INSERTION FORCE: 1KGF/PIN MAX
 - 3-2.REMOVAL FORCE: 3KGF/PIN MIN
 - 3-3.DURABILITY: 25 CYCLES.
- 4.ELECTRICAL PERFORMANCE:
 - 4-1. RATED CURRENT : 10A
 - RATED VOLTAGE : 250V AC
 - 4-2.INSULATION RESISTANCE: 1000MΩ MIN
 - 4-3.CONTACT RESISTANCE : 30mΩ MAX
 - 4-4.WITHSTANDING VOLTAGE: 1500V AC
- 5.PACKAGE SPEC:PAPER PLATE
- 6.P/N:

A2201	T	M	X-X	
SERIES NO:			PLATING:	
CONNECTOR:			A-ALL AU G/F	
T-TERMINAL			C-BRIGHE TIN	
MALE FEMALE:			METAL:	
M-MALE			P-PHOSPHOR BRONZE	
			B-BRASS	

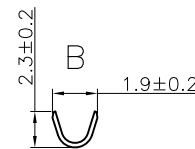
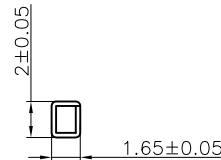
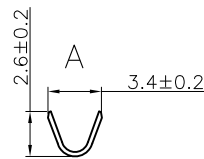

REV.	REVISION RECORD	DATE		GENERAL TOLERANCES		SCALE: 1:1	NAME	DATE	PART.NO:	DWG.NO:	
A0	NEW RELEASE	21.01.13			LINEAR	ANGLES	APPROVED	Wang_jr	21.01.13	A2201TMX-X	
			UNIT:mm	0.00±0.25	X°±3°	DESIGNER	Han_Gao	21.01.13	TITLE:		
			SIZE: A4	0.000±0.10	X'X' ±2°	DRAWN	Zijun_Huang	21.01.13	PITCH 2.20mm小公端 AWG20#~26#		
									REV: A0	SHEET: 1/1	

WanLian Teconology Co., Ltd